



SMART PARKING SENSOR S-LGxx (LoRa-WAN)

S-LGxx accurately detects parking events and filters out magnetic interference. Sensors and algorithms are tuned for ultra-low power consumption, providing continuous vehicle detection and complete monitoring of parking spots.



KEY FEATURES

- Accurate real-time vehicle detection using magnetic sensor and motion detection.
- Sensor auto-calibration on frequent intervals
- Magnetometer failure alert
- Surface mount or in-ground
- Battery life up to 10 years*
- LoRa-WAN compatible
- OTA firmware update
- Operating temperature: -40°C to 85°C
- Relative humidity: up to 100%
- Paired with portable tags which enable driver/vehicle detection upon occupancy (applicable for handicapped and resident parking spots)

LoRa-WAN SPECIFICS

- LoRa-WAN Device class A
- Low battery consumption
- Long range coverage (Tx: 14dBm)
- Adaptive data rate (ADR)
- Frequency bands: EU868 MHz (EU)
- Input Sensitivity: -146 dBm (EU)
- Available for LoRa-WAN v.1.0.1 / v.1.0.2

The sensor transmits data every time the parking spot becomes occupied or vacant and on configurable intervals thereafter. The sensor informs about the current occupancy status, battery voltage and temperature in each message sent.

* Battery life depends on environmental conditions and use. Under average circumstances, an average of 25-30 messages per day using LoRa-WAN communication

CERTIFICATIONS

- IK10 Impact resistance
- IP68 degree of protection
- CE-RED
- LoRa Alliance certified





SMART PARKING SENSORS S-LGxx (LoRa-WAN)

SURFACE MOUNT

- Dimensions:
228.5 mm diameter, 32mm height
- Installation using screws or adhesive

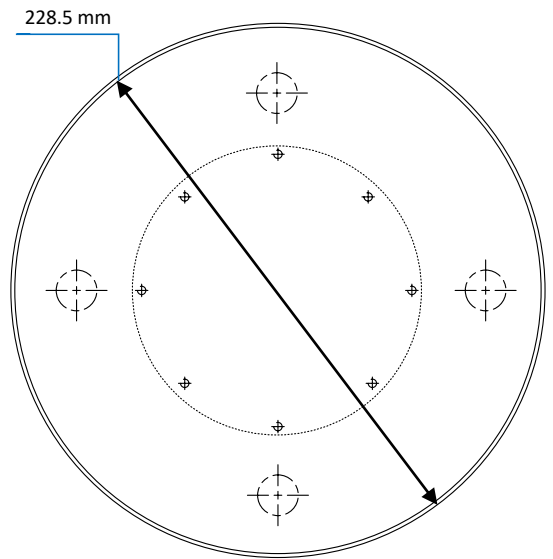
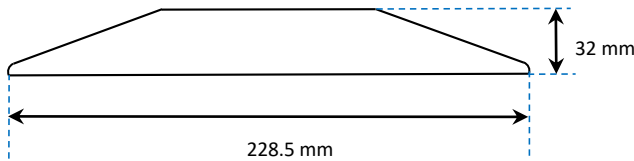

IN-GROUND

- Dimensions:
105mm diameter, 32mm height

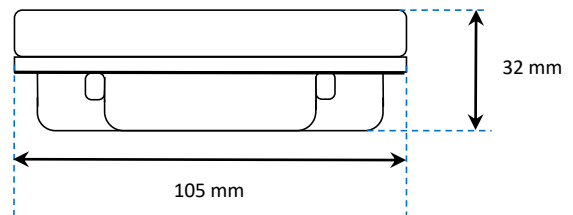
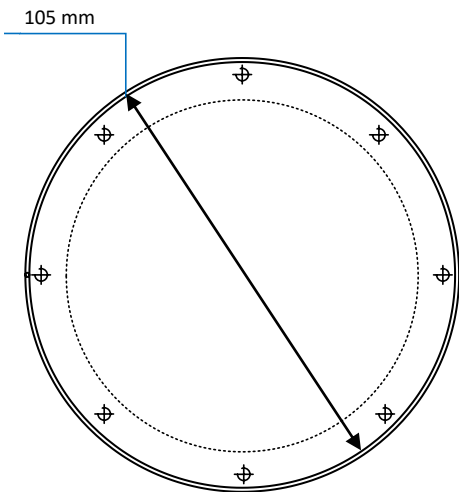

Contact us at info@cicom.gr and www.cicom.gr for more information

Disclaimer: Technical data may change without notice